

REFER TO SHEET 9 FOR  
PROFILE AND GRADING LEGEND

GRAPHIC SCALE  
(In Feet) 1 inch = 20 feet

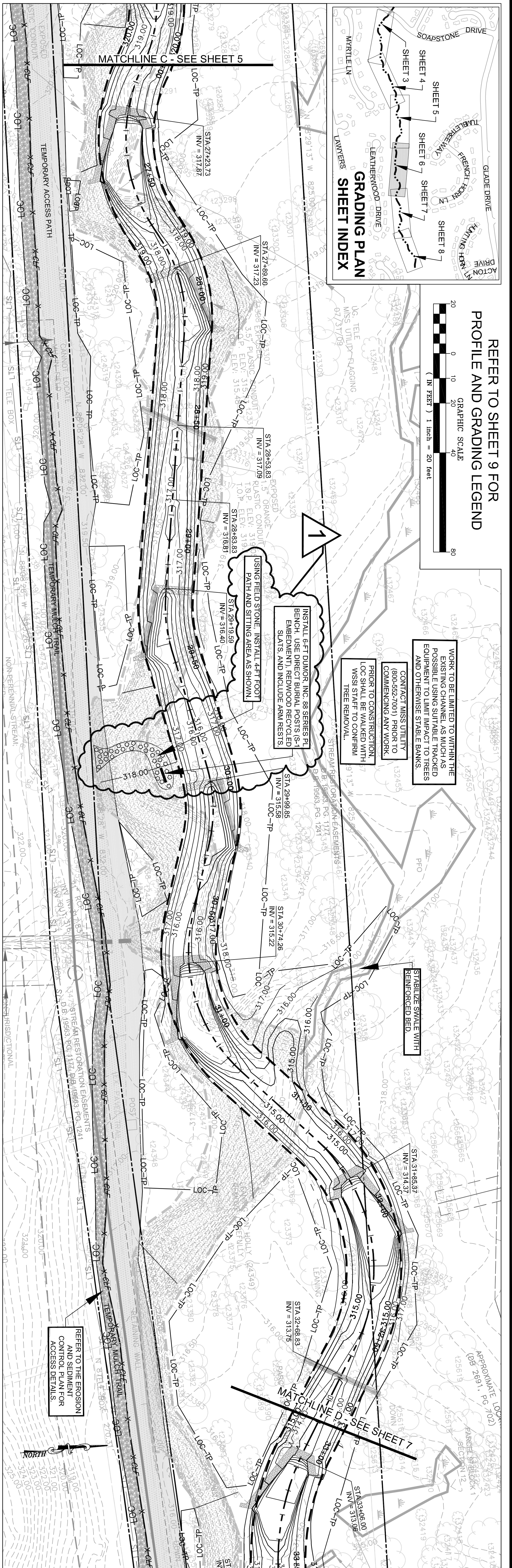

LONGITUDINAL PROFILE - REACH 5 (STA 27+00 TO 32+50)

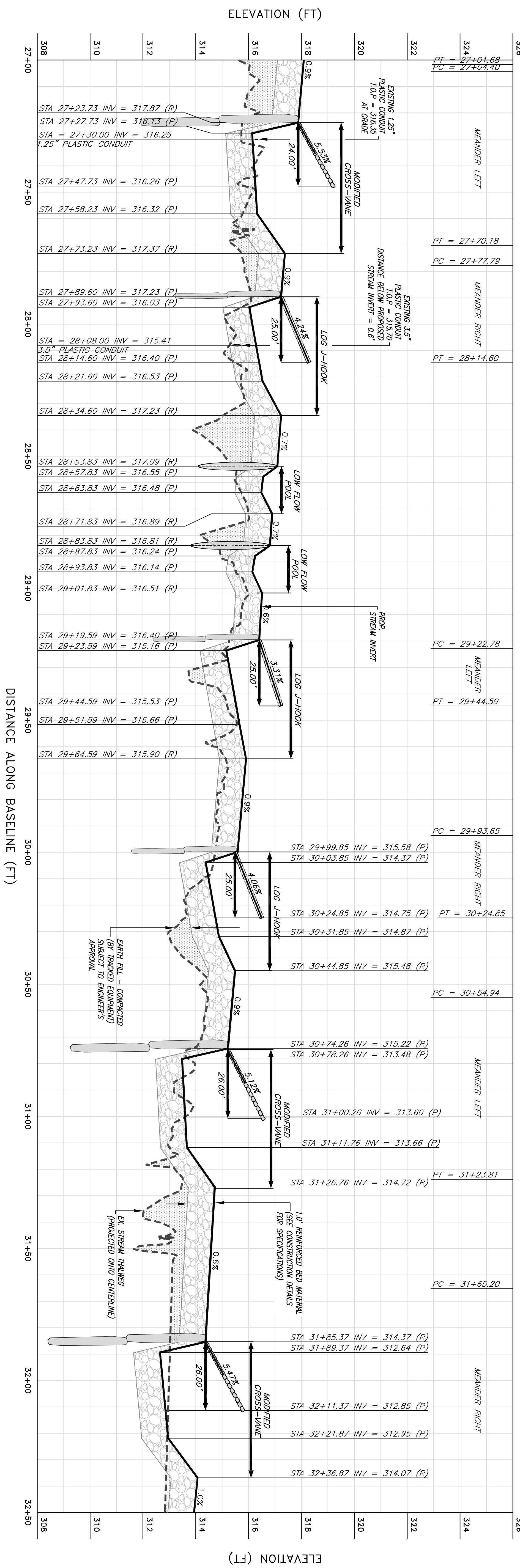

LONGITUDINAL PROFILE  
SCALE: H: 1" = 20'  
V: 1" = 2'

REVISIONS				
No.	Date	Description	Rev. By	App. By
1	9/14/09	Added stone path, bench, and meadow area	KLS	FRG

Horizontal Datum: VCS NAD 83	Vertical Datum: NGVD 29
Boundary and Topo Source: WSSSI and Fairfax Digital Data	

Design: KLS	Draft: KLS	Approved: FRG
-------------	------------	---------------

Computer File Name: GRADING PLAN - REACH 5.dwg	Sheet # 6 of 93
--	-----------------



Northern Virginia Stream Restoration Bank  
The Glade - Reach 5  
Fairfax County, Virginia

Grading Plan and Longitudinal Profile (cont'd)

Copyright © 2009 Wetland Studies and Solutions, Inc.

5300 Wellington Branch Drive, Suite 100 • Gainesville, VA 20155  
Phone 703 679 5600 • Fax 703 679 5601  
wetlandstudies.com