

LONGITUDINAL PROFILE - REACH 5 (STA 38+00 TO 42+86)

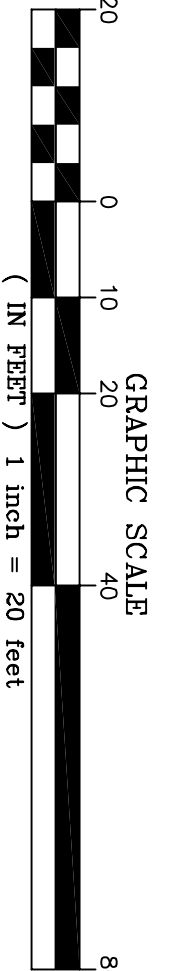
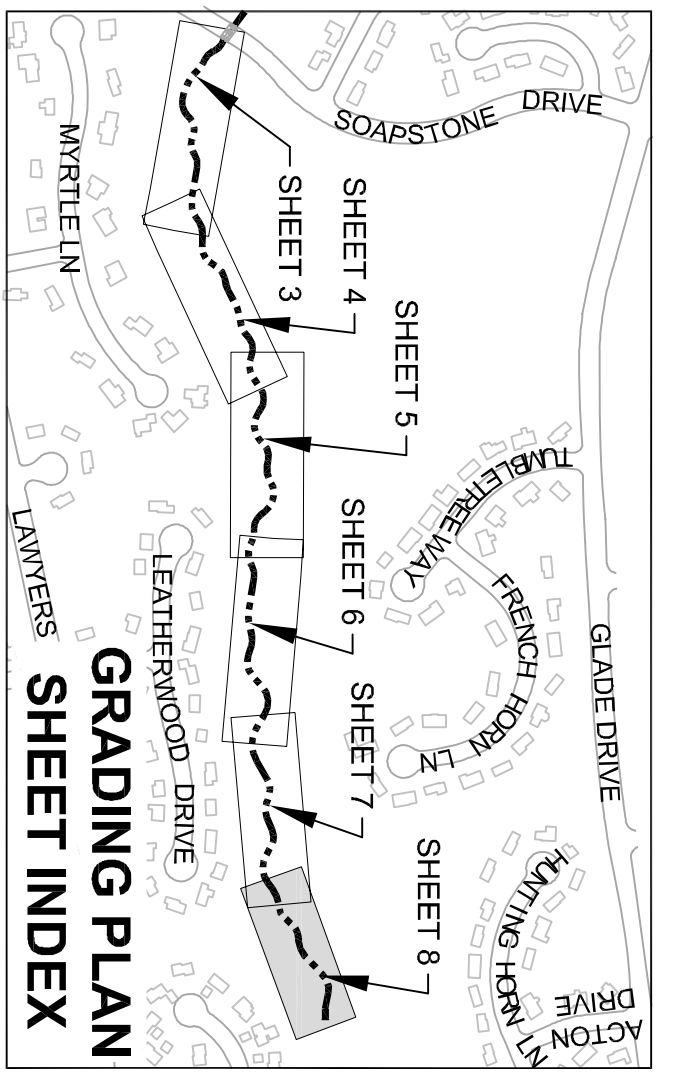
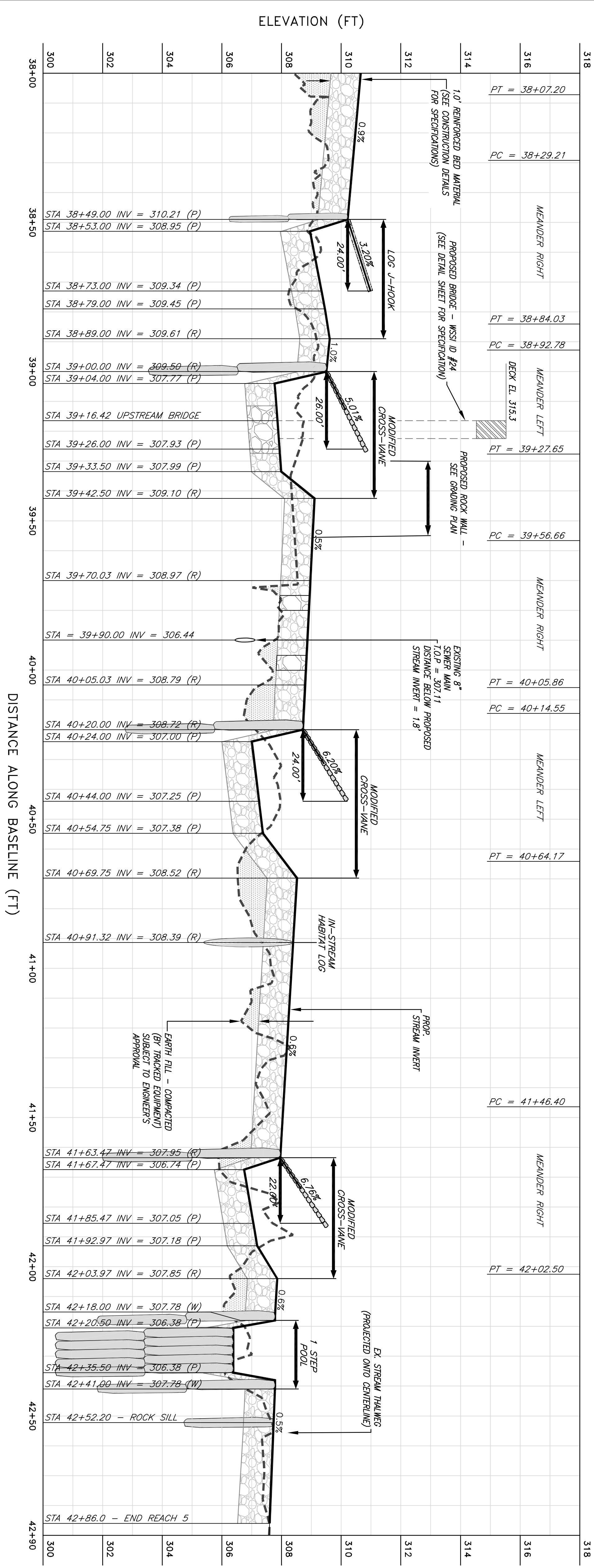

REFER TO SHEET 9 FOR PROFILE AND GRADING LEGEND

REVISIONS		Rev. By	App. By
No.	Date	Description	

Horizontal Datum: VCS NAD 83
Vertical Datum: NGVD 29
Boundary and Topo Source: WSSI and Fairfax Digital Data

DATE: SEPTEMBER 2009 SCALE: 1" = 20'



Northern Virginia Stream Restoration Bank
The Glade - Reach 5
Fairfax County, Virginia

Grading Plan and Longitudinal Profile (cont'd)

Copyright © 2009 Wetland Studies and Solutions, Inc.

Wetland Studies and Solutions, Inc.

5300 Wellington Branch Drive, Suite 100 • Gainesville, VA 20155
Phone 703 679 5600 • Fax 703 679 5601
wetlandstudies.com