

WORK TO BE LIMITED TO WITHIN THE EXISTING CHANNEL AS MUCH AS POSSIBLE USING SUITABLE TRACKED EQUIPMENT TO LIMIT IMPACT TO TREES AND OTHER WILD LIFE BANNS. CONTACT MISS UTILITY (800-555-7001) PRIOR TO COMMENCING ANY WORK. PRIOR TO CONSTRUCTION, LOC SHALL BE WALKED WITH WASSI TREE REMOVAL.

STABILIZE SWALE WITH REINFORCED BED

REFER TO THE EROSION AND SEDIMENT CONTROL PLAN FOR ACCESS DETAILS.

LONGITUDINAL PROFILE - REACH 5 (STA 27+00 TO 32+50)

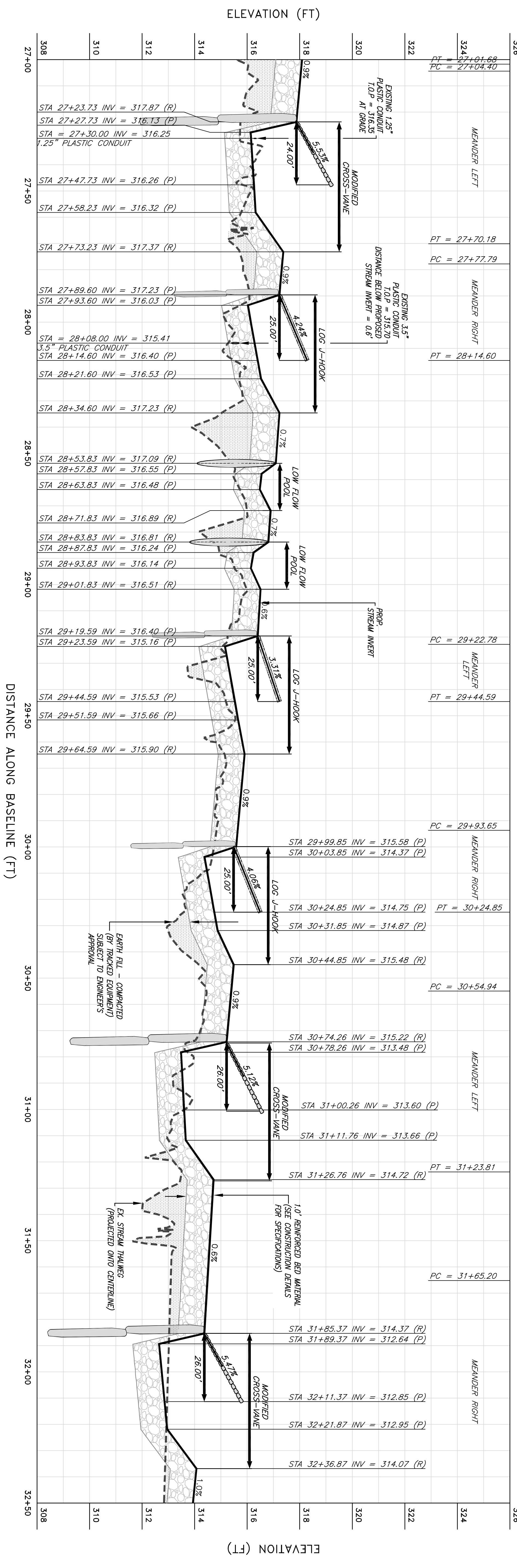

LONGITUDINAL PROFILE SCALE: H: 1" = 20' V: 1" = 2'

REVISIONS		Rev. By	App. By
No.	Date	Description	

Horizontal Datum: VCS NAD 83	Vertical Datum: NGVD 29
Boundary and Topo Source: WSSI and Fairfax Digital Data	

Design: KLS	Draft: KLS	Approved: FRG
Sheet #	6 of 93	



Northern Virginia Stream Restoration Bank
 The Glade - Reach 5
 Fairfax County, Virginia

Grading Plan and Longitudinal Profile (cont'd)

Copyright © 2009 Wetland Studies and Solutions, Inc.

5300 Wellington Branch Drive, Suite 100 • Gainesville, VA 20155
 Phone 703 679 5600 • Fax 703 679 5601
 wetlandstudies.com