

**TREE REMOVAL LEGEND**

- STREAM EASEMENT, TEMPORARY GRADING AND CONSTRUCTION EASEMENT, & INGRESS-EGRESS EASEMENT
- EXISTING PROPERTY LINE
- EXISTING CONTOURS (0.5')
- EXISTING INFRASTRUCTURE
- EXISTING EASEMENTS
- PROPOSED CONTOURS (0.5')
- PROPOSED STREAM CENTERLINE
- LOC-TP LIMITS OF CLEARING
- PROPOSED TOP OF BANK
- PERENNIAL STREAM (TOP OF BANK)
- NONPERENNIAL STREAM (TOP OF BANK)
- ⊗ TREE TO BE REMOVED

**Wetland**  
 Studies and Solutions, Inc.  
 5300 Wellington Branch Drive, Suite 100 • Gainesville, VA 20155  
 Phone: 703.679.5600 • Fax: 703.679.5601  
 wetlandstudios.com

**Northern Virginia Stream Restoration Bank**  
**The Glade - Reach 4B**  
 Fairfax County, Virginia  
**Tree Removal Plan**

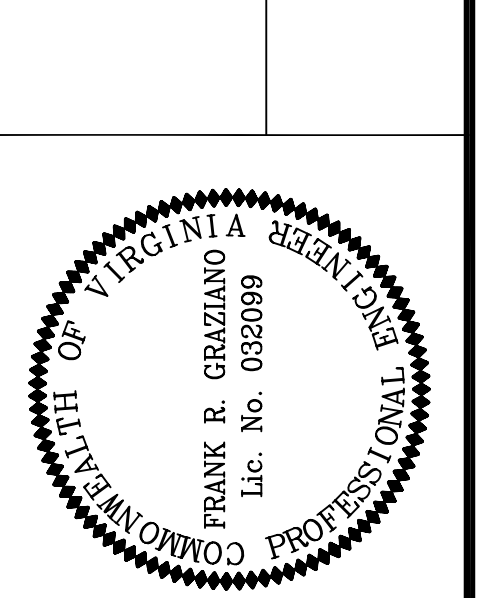

**REVISIONS**

No.	Date	Description	App. By	Rev. By
1	5/26/09	Revised LOC / TP & temporary access path	FRG	SLT
6	5/26/09	Added tree(s) to be removed (22260)	FRG	SLT

DATE: MAY 2009  
 SCALE: 1" = 20'

Horizontal Datum: VCS NAD 83  
 Vertical Datum: NGVD 29  
 Boundary and Topo Source: WSSI and Fairfax Digital Data

Design	Draft	Approved
SRP	RDD	FRG

Sheet #  
**23 of 80**

Computer File Name:  
 I:\2009\2010\10-ACR\09-ENG\10-Tree Removal.dwg

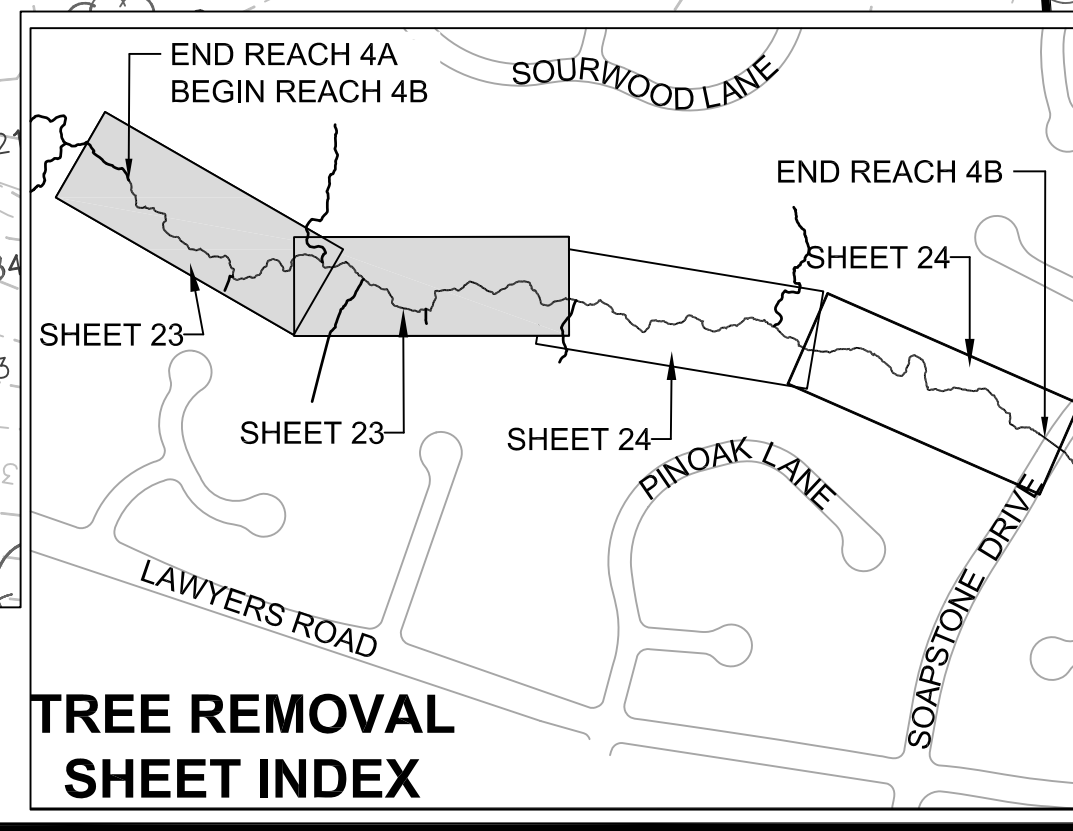

**THIS SHEET TO BE USED FOR TREE REMOVAL PLAN PURPOSES ONLY.**

GRAPHIC SCALE  
 20 0 10 40 80  
 (IN FEET) 1 inch = 20 feet