

Wetland
Studies and Solutions, Inc.

5300 Wellington Branch Drive, Suite 100 • Gainesville, VA 20155
Phone: 703 679 5600 • Fax: 703 679 5601
wetlandstudies.com

Northern Virginia Stream Restoration Bank
The Glade - Reach 3
Fairfax County, Virginia

Tree Exhibit (cont'd)

Copyright © 2009 Wetland Studies and Solutions, Inc.

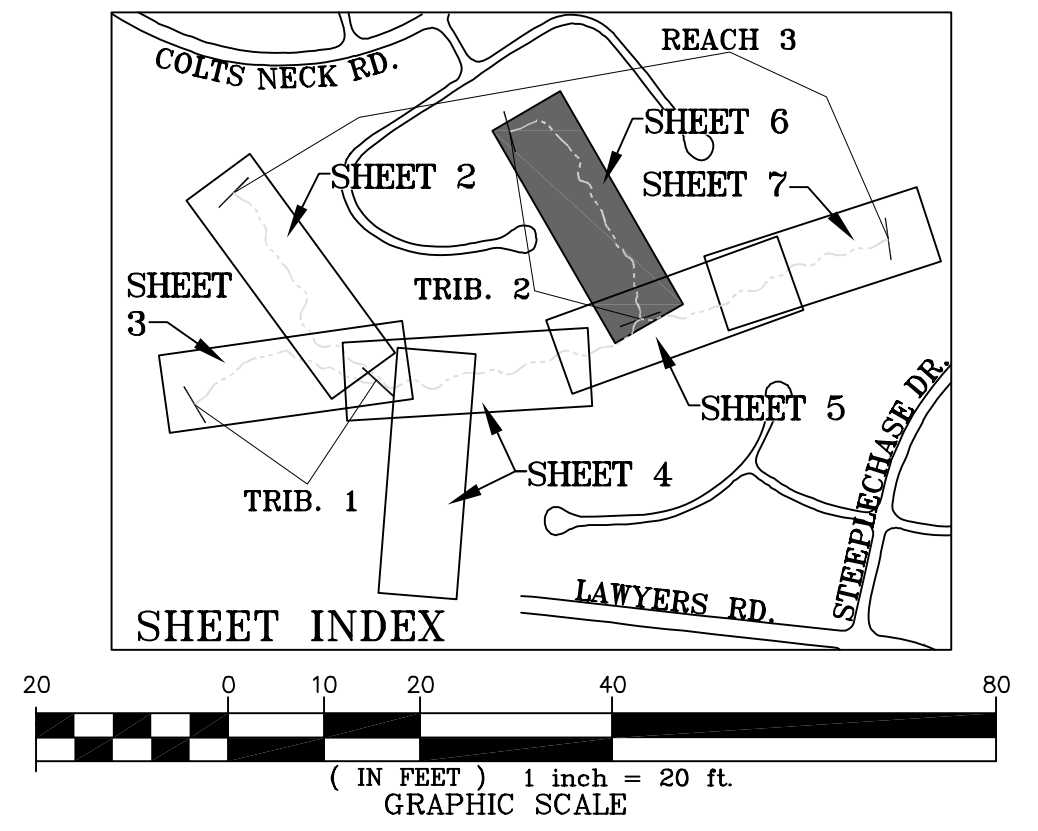
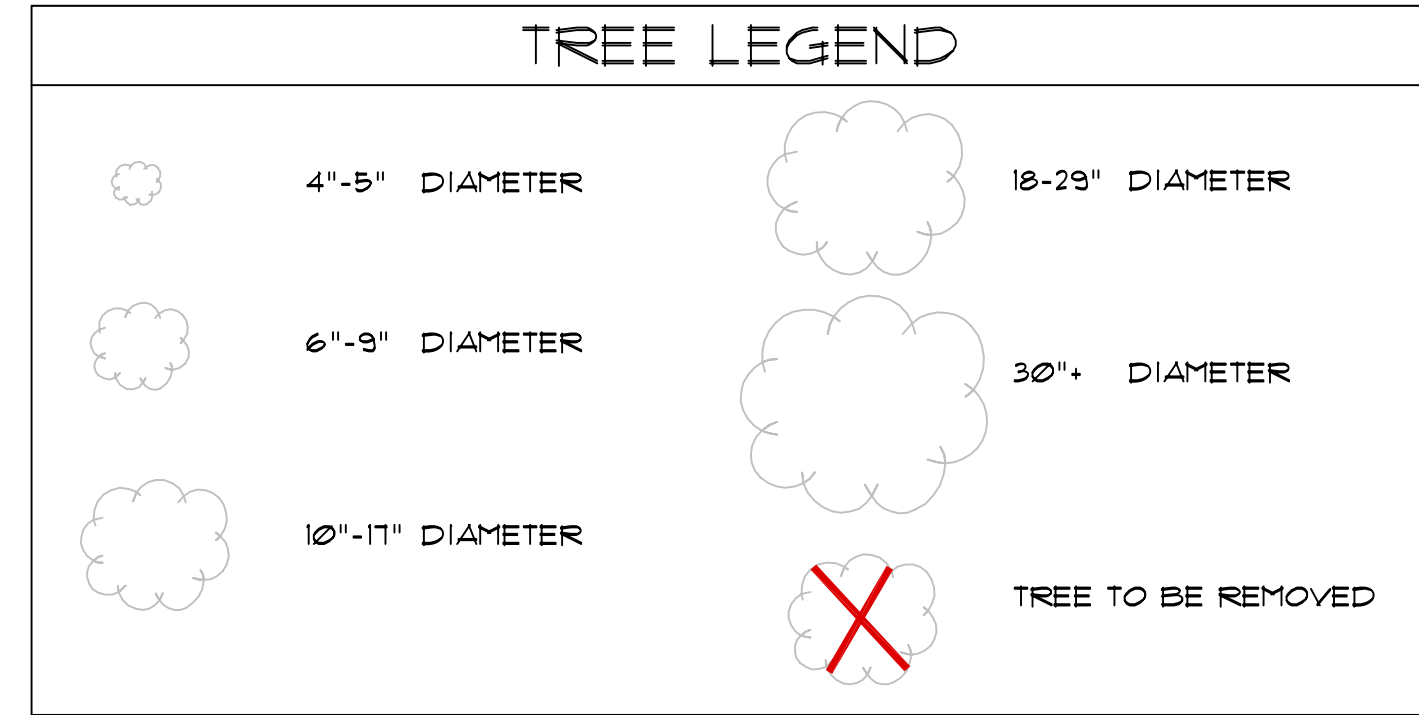

REFER TO 1 FOR GRADING
LEGEND AND NOTES.

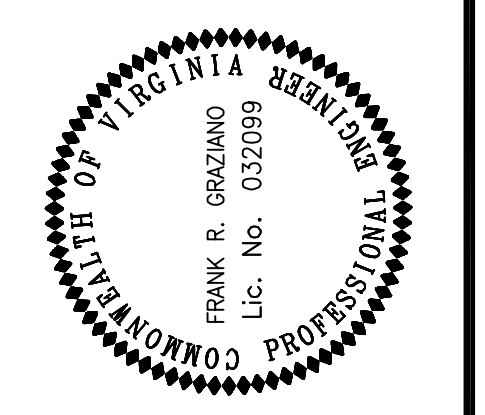

REVISIONS

No.	Date	Description	App. By

DATE: DECEMBER 2008 SCALE: 1" = 20'

Horizontal Datum: VCS NAD 83
Vertical Datum: NGVD 29
Boundary and Topo Source: WSSI and Fairfax Digital Data

Design	Draft	Approved
SLT	SLT	FRG

Sheet #
6 of 7

Computer File Name:
1:2009062013:CA0404ENR:14Plan4 - Tree Removal GRADING PLAN.dwg