

SEE SHEET 4 FOR GRADING LEGEND AND NOTES.

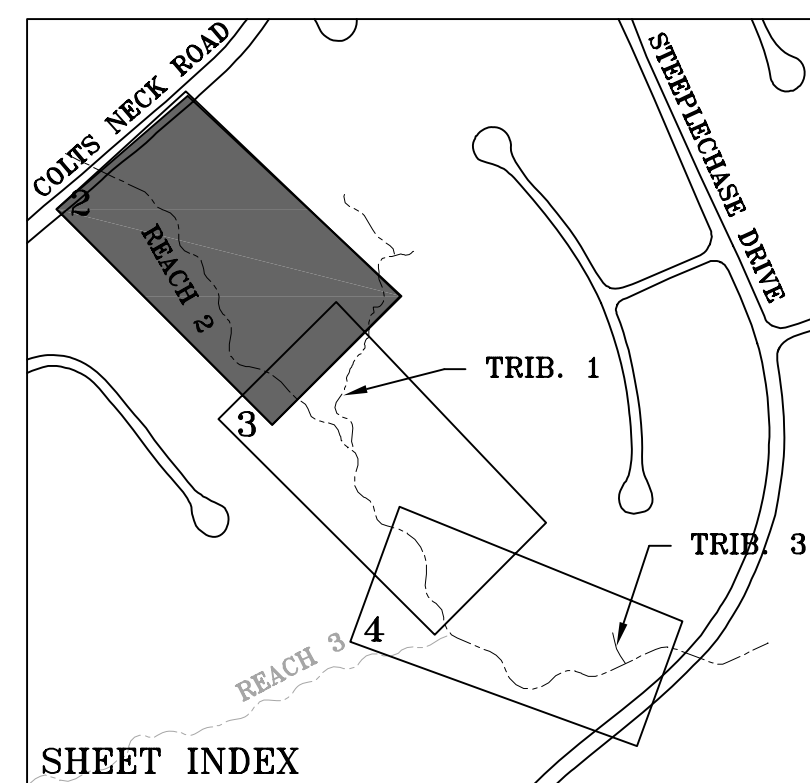

	4"-5" DIAMETER		10"-29" DIAMETER
	6"-9" DIAMETER		30" DIAMETER
	10"-11" DIAMETER		TREE TO BE REMOVED

3300 Wellington Branch Drive, Suite 100 • Gainesville, VA 20155
 Phone: 703 679 5600 • Fax: 703 679 5601
 wetlandstudies.com

Northern Virginia Stream Restoration Bank
 The Glade - Reach 2
 Fairfax County, Virginia

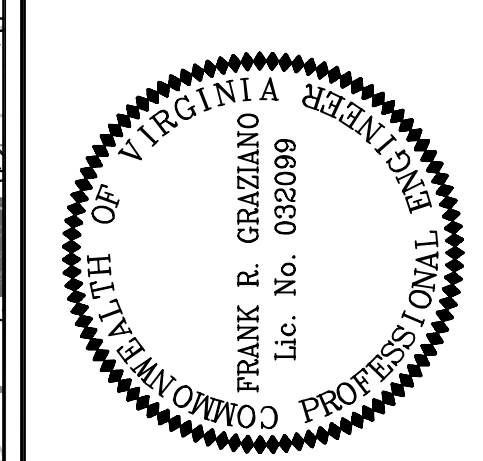

No.	Date	Description	App. By

DATE: DECEMBER, 2008 SCALE: 1" = 20'

Horizontal Datum: VCS NAD 83
 Vertical Datum: NGVD 29
 Boundary and Topo Source: WSSI and Fairfax Digital Data

Design	Draft	Approved
JBP	JBP	FRG

Sheet #
2 of 4

Computer File Name:
I:\33096\2010\33096\ENR\18\Plan - Tree Removal\GRADING PLAN & PROFILE 01.dwg

Copyright © 2009 Wetland Studies and Solutions, Inc.