

LONGITUDINAL PROFILE - LAKE ANNE WEST (STATIONS 14+00 TO END)

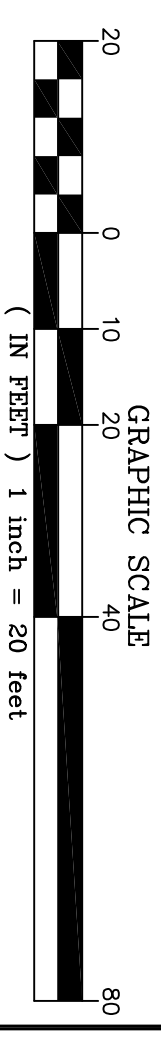
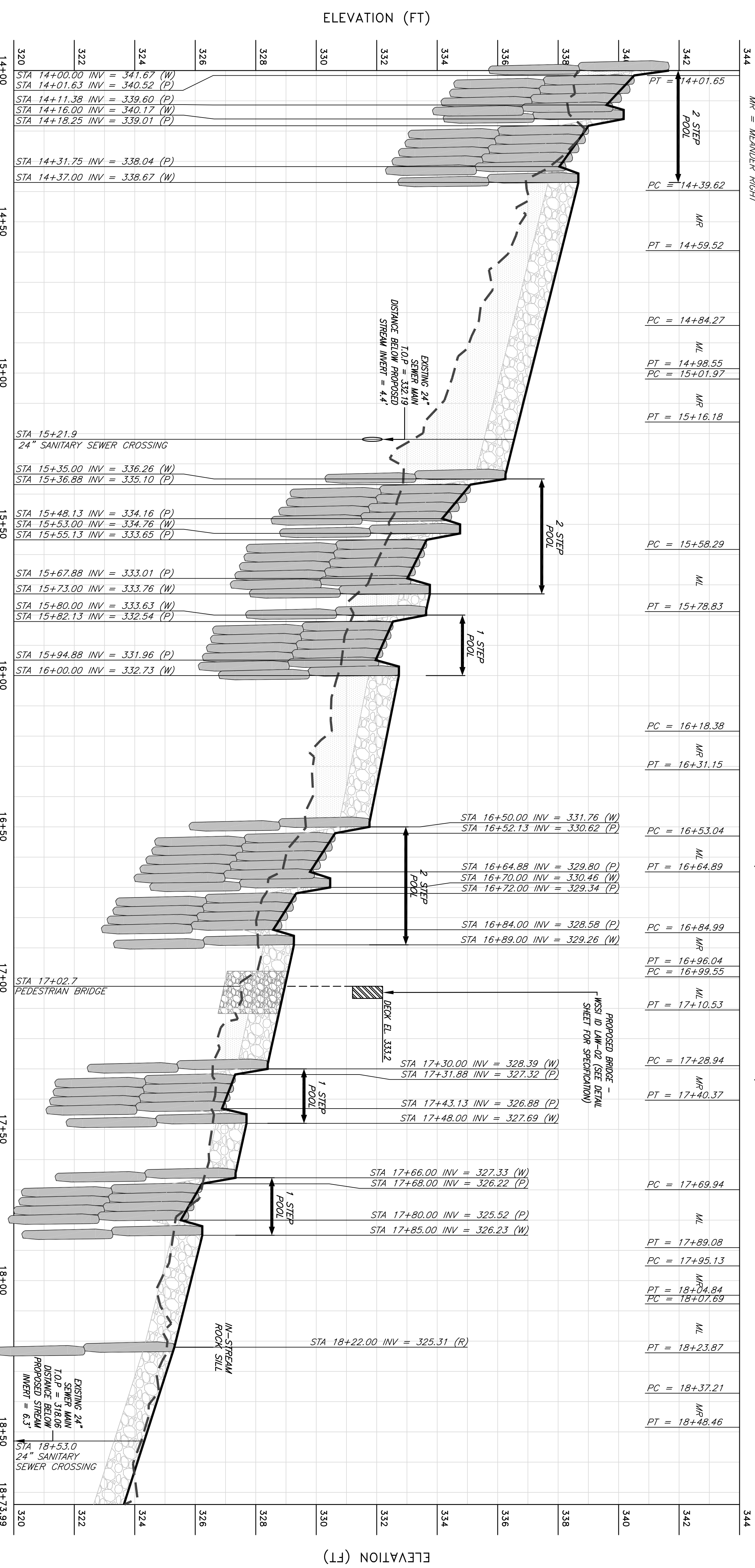

SEE SHEET 5 FOR GRADING AND LONGITUDINAL PROFILE LEGENDS AND NOTES.

LONGITUDINAL PROFILE
SCALE: H: 1" = 20'
V: 1" = 2'

WORK TO BE LIMITED TO WITHIN THE BOUNDARY OF THE PROJECT AS SHOWN ON THE PLANS. ANY WORK BEYOND THE BOUNDARY SHALL BE NOTIFIED IN ADVANCE.
CONTACT MISS UTILITY (800-552-7001) PRIOR TO COMMENCING ANY WORK.
PRIOR TO CONSTRUCTION, LOC SHALL BE WALKED WITH WSS STAFF TO CONFIRM TREE REMOVAL.

PEDESTRIAN BRIDGE - SEE EROSION AND SEDIMENT CONTROL PLAN FOR DETAILS.
REPLACE EXISTING BRIDGE (WSS) TO REMAIN. NO RESTON FLAG. #1 WITH #4 WIDE PEDESTRIAN BRIDGE. SEE BRIDGE DETAILS SHEET FOR DESIGN AND DETAILS. TRAIL SHALL BE INTO EXISTING TRAIL AS SHOWN AND BE 8' WIDE. 2" THICK TYPE I ASPHALT BENEATH THE SHOULDER PORTION OF THE PARKWAY COUNTY PAVEMENT SECTION (6+000). SUBDRAINS, TRAILS, AND REGULATION.

TRIBUTARY #4 REMOVE & SECTION OF EXISTING 15" RCP TO RAISE INVERT OUT ELEVATION TO APPROX. 329.00'. REPLACE HEADWALL. SEE PROFILE ON THIS SHEET.

CONTRACTOR SHALL TAKE EXTRA CARE WHEN WORKING AROUND THE EXISTING SANITARY SEWER LINES. CONTRACTOR SHALL NOT SET EQUIPMENT ON THE LINE, EXCAVATE, OR POUND ROCKS INTO PLACE OVER THE LINE, ETC.
NO RIPRAP SHALL BE INSTALLED OVER SANITARY SEWER CROSSING. PLACE 5' OF CLASS II RIPRAP UP TO BANKFILL, UPSTREAM AND DOWNSTREAM OF THE CROSSING. REINFORCED BED MATERIAL SHALL BE PLACED DIRECTLY ON TOP OF THE CROSSING (5' WIDTH) TO COVER PIPE BETWEEN RIPRAP STABILIZATION. SALVAGED COBBLE/GRAVEL/SUBSTRATE SHALL BE PLACED OVER CLASS II RIPRAP AND PIPE.

REVISIONS		Rev. By	App. By
No.	Date	Description	

Horizontal Datum: VCS NAD 83
Vertical Datum: NGVD 29
Boundary and Topo Source: WSS and Fairfax Digital Data

Design	Draft	Approved
KLP	KLP	FRG

Sheet # 4 of 51

DATE: OCTOBER 2011 SCALE: 1" = 20'



Northern Virginia Stream Restoration Bank
Lake Anne West
Fairfax County, Virginia

Grading Plan and Longitudinal Profile (cont'd)

Copyright © 2011 Wetland Studies and Solutions, Inc.

Wetland
Studies and Solutions, Inc.

5300 Wellington Branch Drive, Suite 100 • Gainesville, VA 20155
Phone 703 679 5600 • Fax 703 679 5601
wetlandstudies.com