

**DRAFT**

- PRELIMINARY PLAN LEGEND**
- TEMP. GRADING & CONST. ESMNT. & INGRESS-EGRESS ESMNT
  - PROPOSED STREAM ESMNT
  - PROPOSED STREAM ESMNT, TEMP. GRADING & CONST. ESMNT. & INGRESS-EGRESS ESMNT
  - EXISTING CONTOURS (0.5')
  - EXISTING INFRASTRUCTURE
  - FLOODPLAIN EASEMENT
  - NON-PERENNIAL STREAM (EXISTING TOP OF BANK)
  - LTS - LIMITS OF TREE SURVEY
  - PROPOSED BANKFULL TOP OF BANK
  - PROPOSED CENTERLINE
  - PROPOSED CONTOURS (0.5')
  - LOMA - LIMITS OF MOWED AREA
  - NEST
  - CAVITY
  - VERNAL POOL
  - SNAG
  - DEN
  - ACCESS PATH
  - TREE TO BE REMOVED
  - EXISTING 100-YR FLOOD ELEVATION
  - PROPOSED 100-YR FLOOD ELEVATION
  - LIMITS OF CLEARING/TREE PROTECTION FENCE
  - PEDESTRIAN BARRICADE

**STREAM LENGTH:  
LAKE ANNE WEST = 874'**

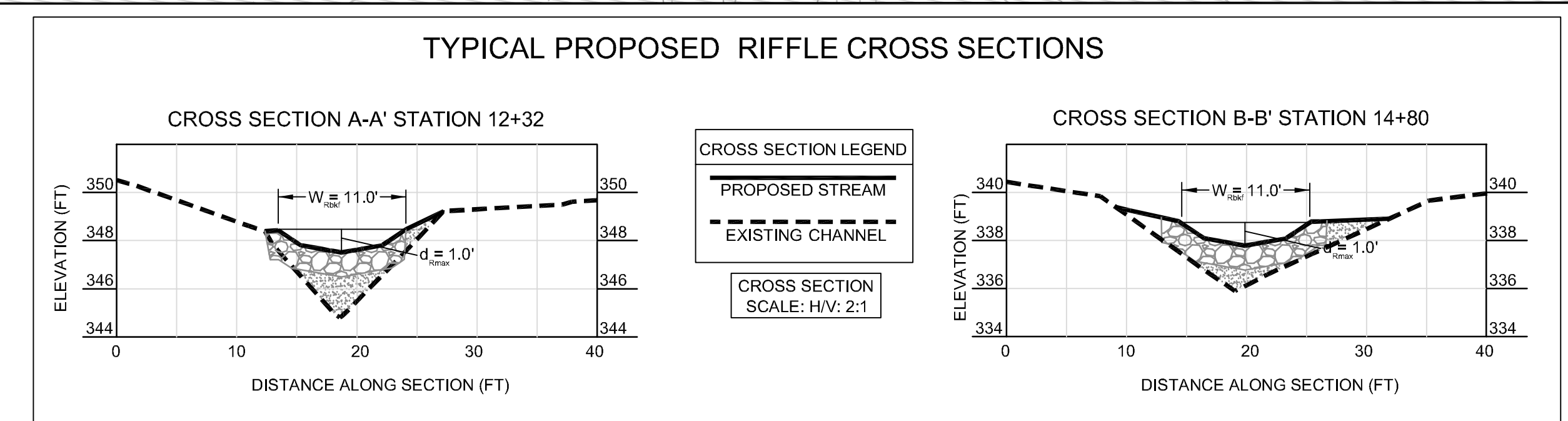
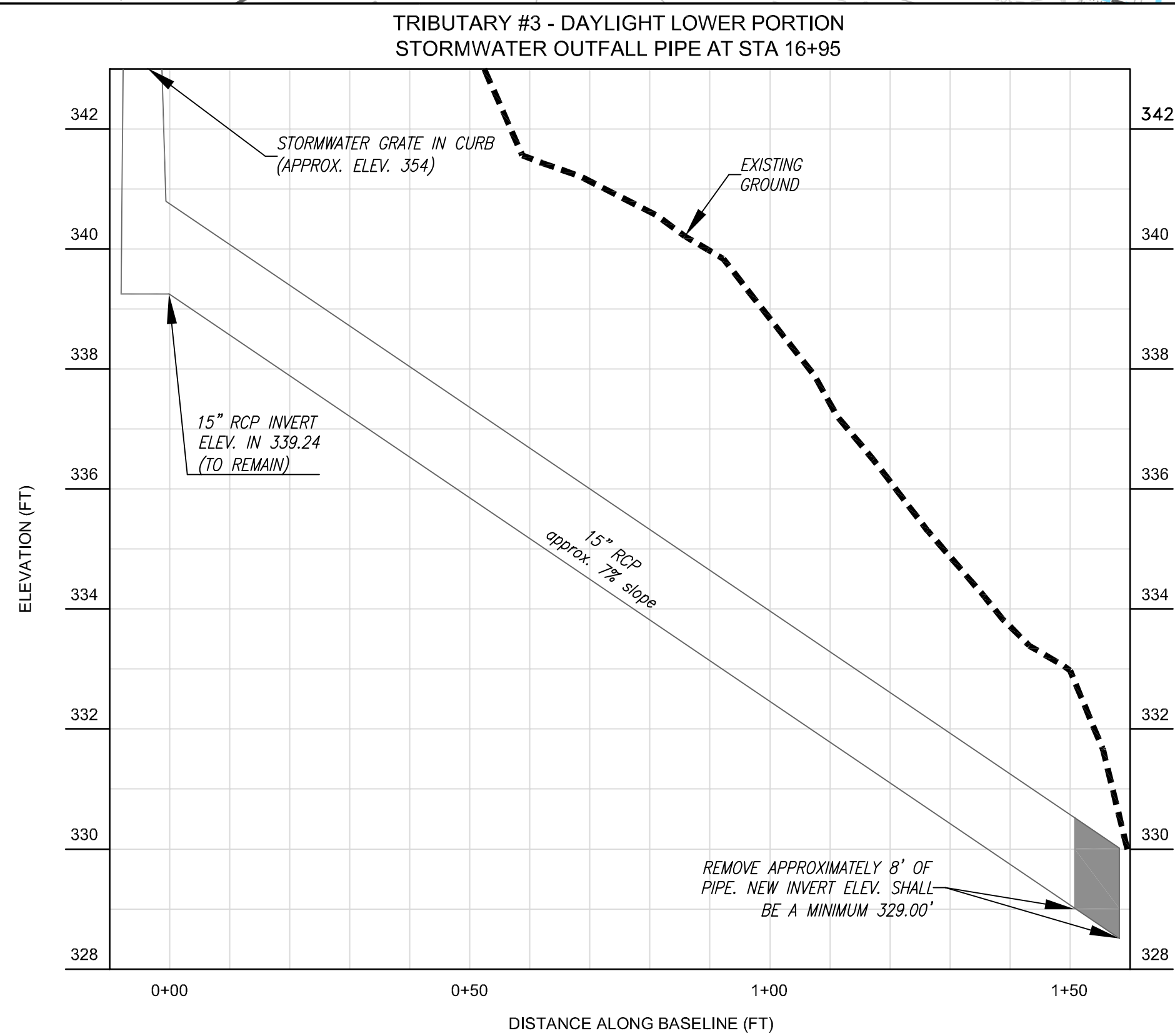
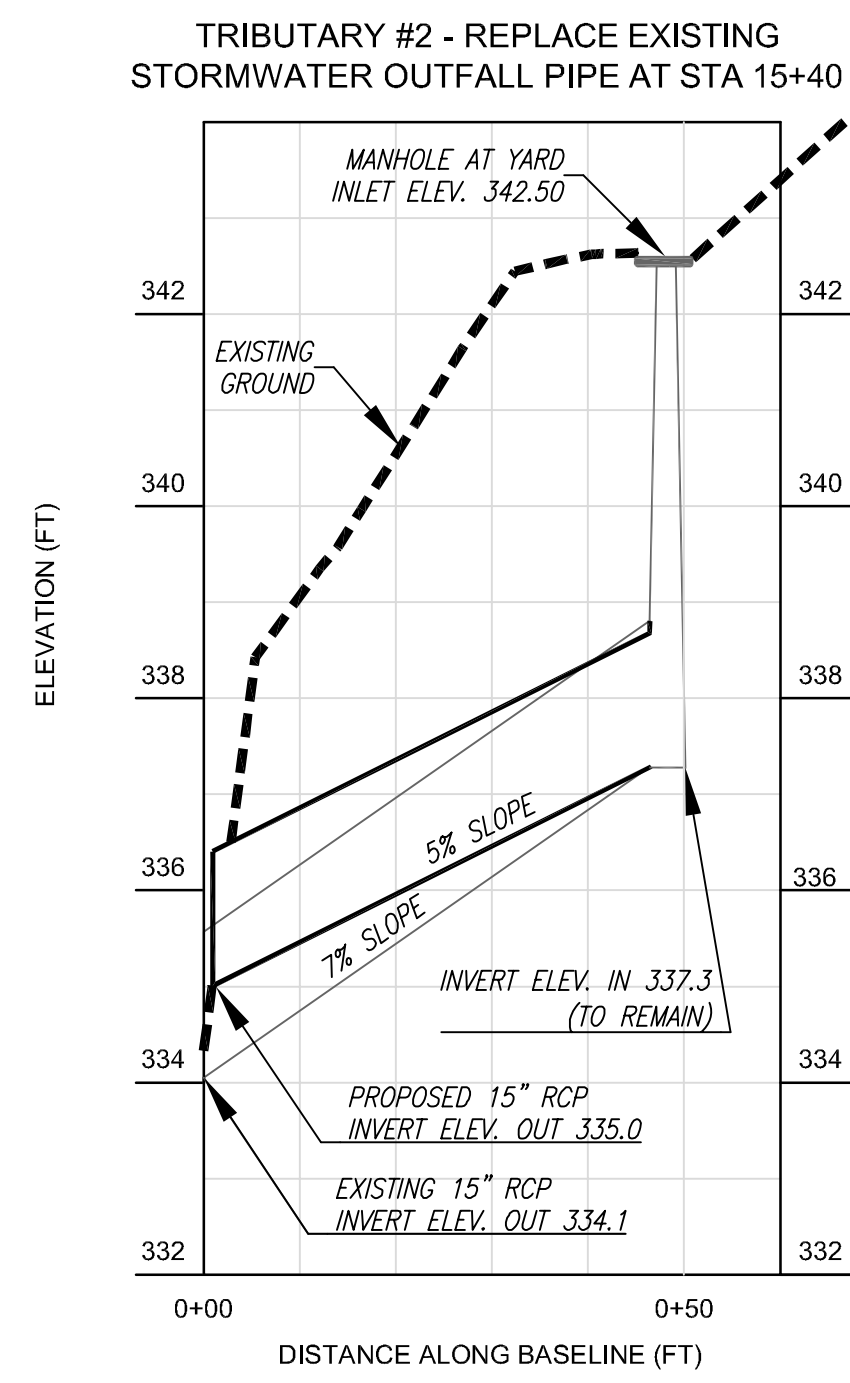
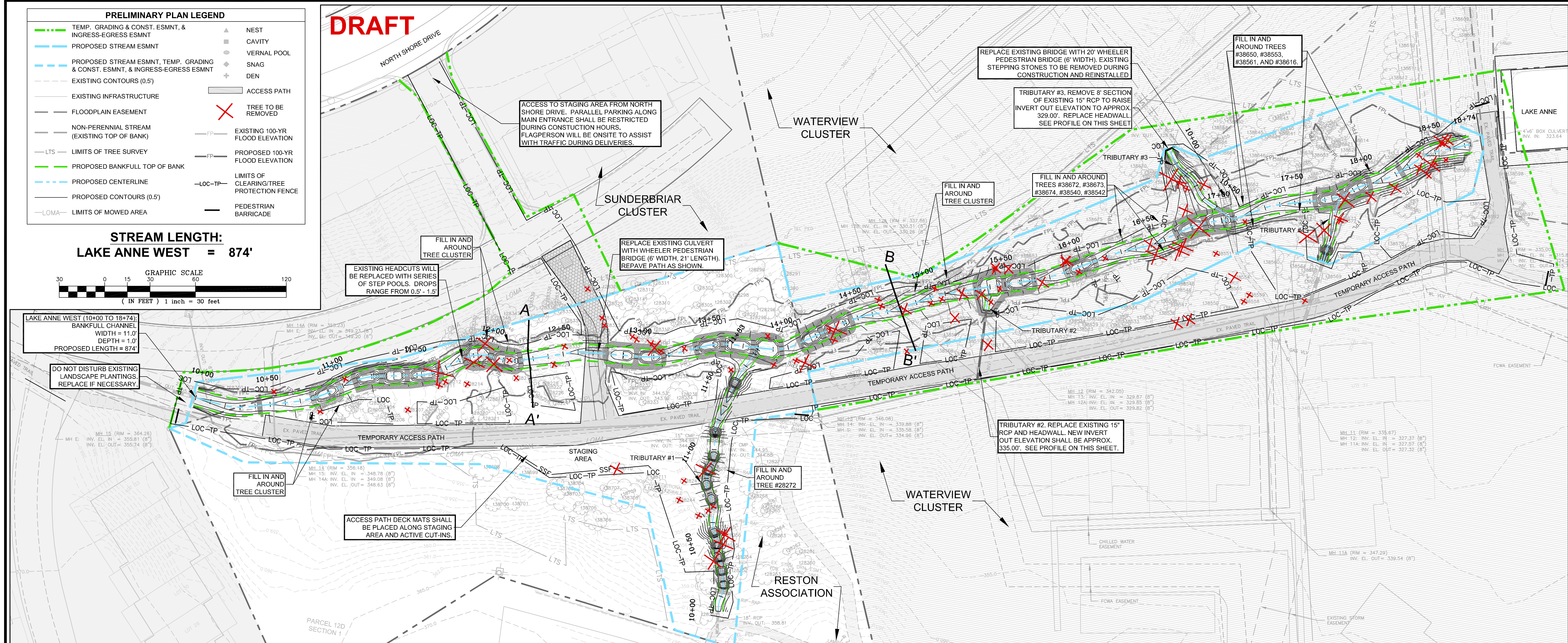
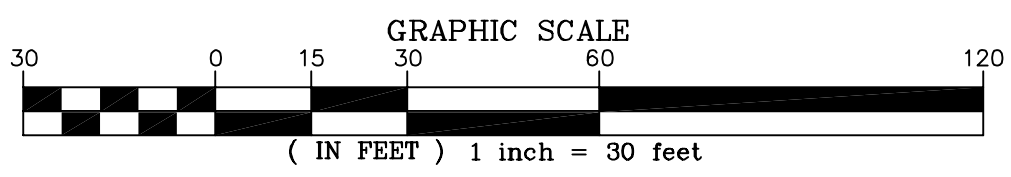

Northern Virginia Stream Restoration Bank  
Lake Anne West  
Fairfax County, Virginia

**Wetland Studies and Solutions, Inc.**

5300 Wellington Branch Drive, Suite 100 • Gainesville, VA 20155  
Phone 703 679 5600 • Fax 703 679 5601  
wetlandstudies.com

**Preliminary Plan**

Copyright © 2010 Wetland Studies and Solutions, Inc.

REVISIONS				H. D.: VCS NAD 83 V. D.: NGVD 29					
No.	Date	Description	Rev. By	App. By	No.	Date	Description	Rev. By	App. By

Boundary and Topo Source:  
WSSI and Fairfax Digital Data

Design: KLP    Draft: KLP    Approved: FRG

Sheet #  
**1 of 2**

Computer File Name:  
D:\Projects\2010\2010-02-23\2010-02-23-01\2010-02-23-01-Preliminary Plan.dwg

DATE: DECEMBER 03, 2010    SCALE: 1" = 30'    C.I. = 0.5'