

IT IS ASSUMED THAT ALL TREES WITHIN THE LIMITS OF CLEARING WILL NOT BE REMOVED. PRIOR TO CONSTRUCTION THE LIMITS OF CLEARING (LOC) SHALL BE WALKED BY WSSI STAFF TO CONFIRM TREE REMOVAL. IN THE EVENT THAT THE CONTRACTOR BELIEVES A TREE WITHIN THE LOC COULD BE SAVED, THE CONTRACTOR SHALL CONTACT WETLAND STUDIES AND SOLUTIONS, INC. AND HAVE THE PROJECT ENGINEER DETERMINE IF THE TREE SHOULD BE SAVED OR REMOVED.

NO TREE IMPACTS ARE ANTICIPATED IN THE ACCESS AND STAGING AREAS ON INLET CLUSTER PROPERTY.

TREE REMOVAL LEGEND	
---	PROPERTY BOUNDARY
---	COMBINED PROPERTY BOUNDARY, STREAM ESMT, AND TEMP. GRADING & CONST. / INGRESS-EGRESS ESMT
---	COMBINED STREAM ESMT AND TEMP. GRADING & CONST. / INGRESS-EGRESS ESMT
---	TEMP. GRADING & CONSTRUCTION ESMT, / INGRESS-EGRESS ESMT
---	COUNTY MAPPED RPA
---	EXISTING CONTOURS (0.5')
---	NONPERENNIAL STREAM (EXISTING TOP OF BANK)
---	PROPOSED CONTOURS (0.5')
---	PROPOSED STREAM CENTERLINE
---	PROPOSED TOP OF BANK
LOC-TP	LIMITS OF CLEARING / TREE PROTECTION
TP	TREE PROTECTION
LOC	LIMITS OF CLEARING
X-CLF	CHAINLINK FENCE
---	10-FOOT PEDESTRIAN GATE
X	TREE TO BE REMOVED

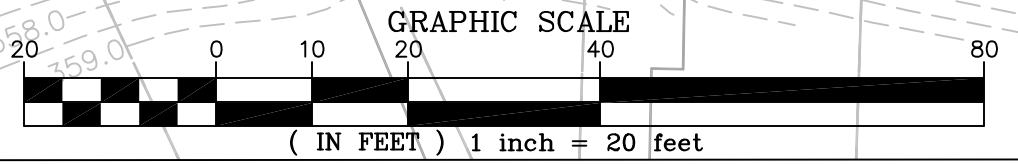
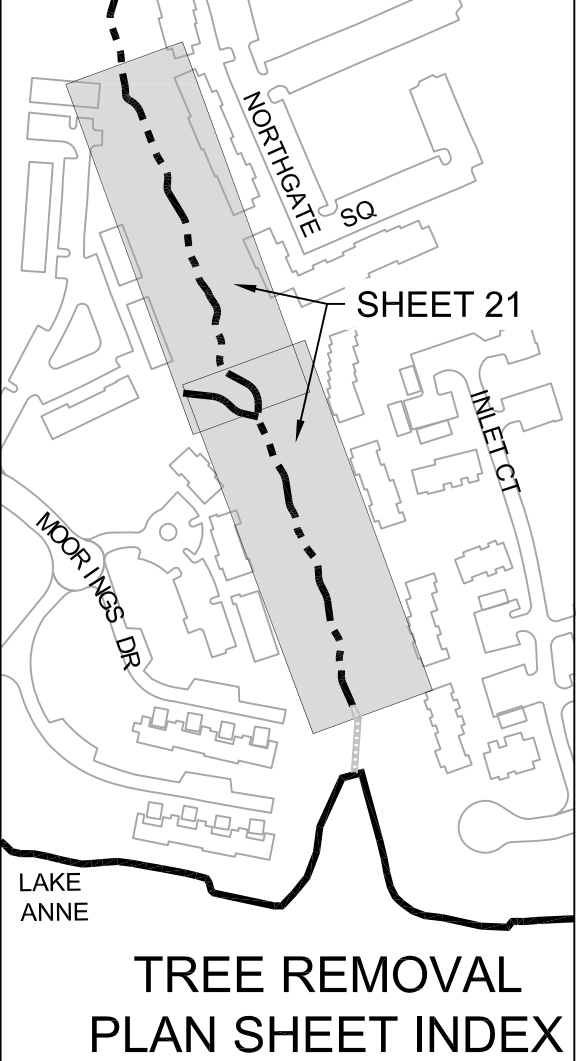

THIS SHEET TO BE USED FOR TREE REMOVAL PURPOSES ONLY.



REVISIONS		App. By	By	Date	Description
No.	Date				

Horizontal Datum: VCS NAD 83
Vertical Datum: NGVD 29
Boundary and Topo Source: WSSI and Fairfax Digital Data

Design	Draft	Approved
NAS	NAS	FRG

Sheet #
21 of 49

Computer File Name:
L:\2006\2010\02\CA030\03\INLET-03\Sheet
TREE REMOVAL PLAN 01.dwg