

GRADING LEGEND

---	PROPERTY BOUNDARY		PROPOSED ROCK STEP
- - -	COMBINED PROPERTY BOUNDARY, STREAM ESMNT, AND TEMP. GRADING & CONST. / INGRESS-EGRESS ESMNT		PROPOSED IMBRICATED ROCK WALL
- · - · -	COMBINED STREAM ESMNT AND TEMP. GRADING & CONST. / INGRESS-EGRESS ESMNT		PROPOSED STEP POOL
- · - · - · - · -	TEMP. GRADING & CONSTRUCTION ESMNT / INGRESS-EGRESS ESMNT		ACCESS PATH
- - - - -	EXISTING EASEMENTS		LIMITS OF CLEARING
- - - - -	EXISTING INFRASTRUCTURE		CHAINLINK FENCE
- - - - -	EXISTING CONTOURS (0.5')		
- - - - -	PROPOSED CONTOURS (0.5')		
- - - - -	NONPERENNIAL STREAM (EXISTING TOP OF BANK)		
- - - - -	PROPOSED CENTERLINE		
- - - - -	PROPOSED TOP OF BANK		
- · - · -	LIMITS OF CLEARING / TREE PROTECTION		

PROFILE LEGEND

	EXISTING STREAM INVERT
	PROJECTED TO PROPOSED CENTERLINE
	PROPOSED STREAM INVERT
	ALONG PROPOSED CENTERLINE
	STRUCTURE ROCKS
	REINFORCED BED
	EARTH FILL
	PC & PT LOCATIONS WITH LINE OR CURVE DESIGNATION REFERENCED FROM STAKEOUT DATA

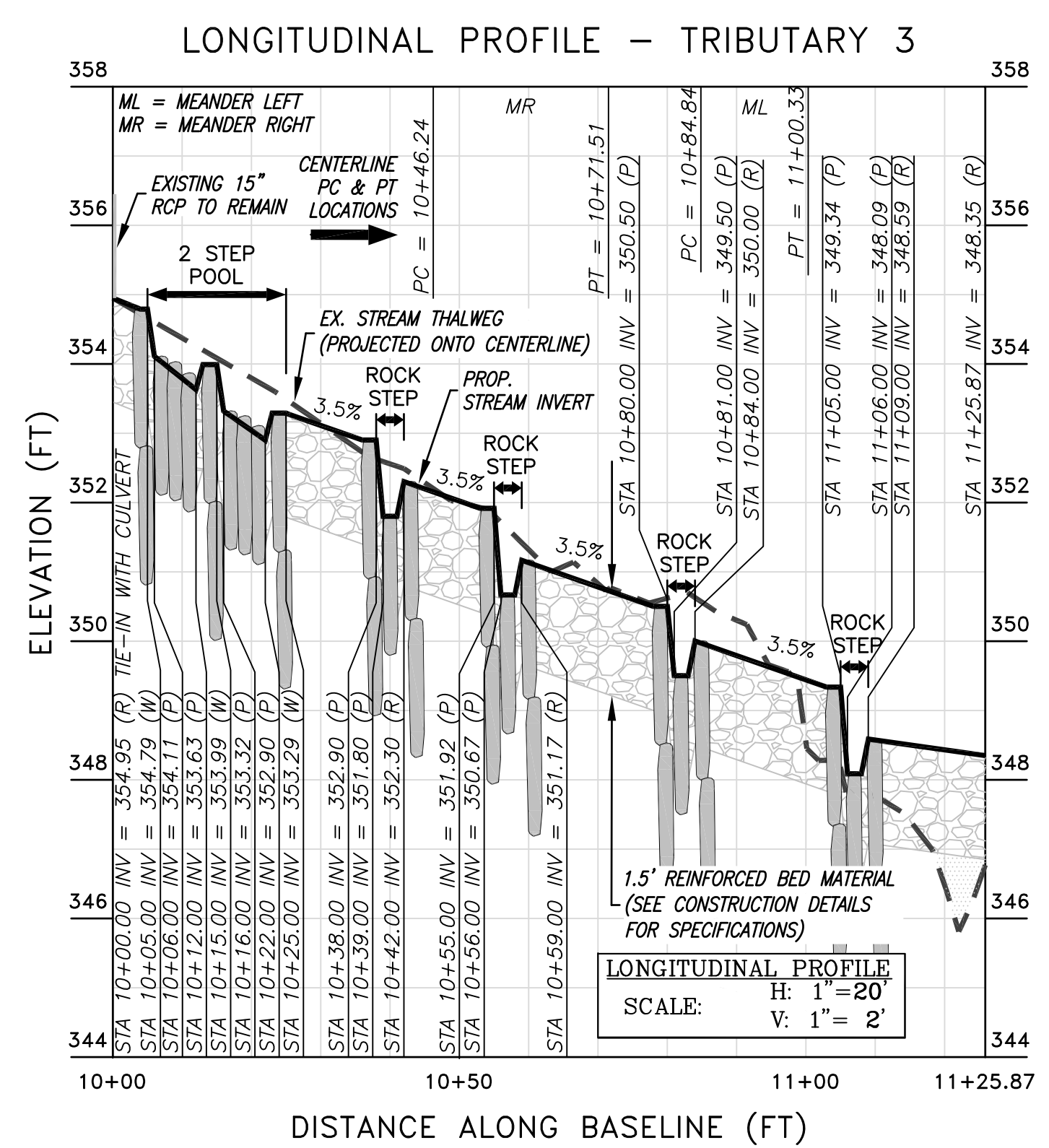

- #### GRADING NOTES:
- PROPOSED CONTOURS ARE INTENDED TO DEPICT OVERALL GRADING CONCEPT. DUE TO IRREGULARITY OF ROCK SHAPES, CONTOURS DEPICTING POOL GRADING WITHIN STRUCTURES ARE APPROXIMATE. SPECIFICATIONS FOR GRADING IN VICINITY OF STRUCTURES ARE PROVIDED IN TYPICAL SECTIONS AND CONSTRUCTION DETAILS. THE SPECIFICATIONS IN THE CONSTRUCTION DETAILS TAKE PRECEDENCE OVER THE CONTOURS DEPICTED ON THE GRADING PLAN.
 - TREE PROTECTION FENCING SHALL BE PLACED AROUND ALL AREAS OF TREES TO BE PRESERVED ADJACENT TO THE LIMITS OF CLEARING AND GRADING.
 - IT IS ASSUMED THAT ALL TREES WITHIN THE LIMITS OF CLEARING WILL NOT BE REMOVED. PRIOR TO CONSTRUCTION THE LIMITS OF CLEARING (LOC) SHALL BE WALKED BY WSSI STAFF TO CONFIRM TREE REMOVAL. IN THE EVENT THAT THE CONTRACTOR BELIEVES A TREE WITHIN THE LOC COULD BE SAVED, THE CONTRACTOR SHALL CONTACT WETLAND STUDIES AND SOLUTIONS, INC. AND HAVE THE PROJECT ENGINEER DETERMINE IF THE TREE SHOULD BE SAVED OR REMOVED.
 - REFER TO THE GEOMETRY PLAN FOR TRAVERSE LOCATIONS AND ELEVATIONS.
 - ALL STREAM BEDS REQUIRE 1.5 FT OF REINFORCED BED MATERIAL. FOR CLARITY IT IS NOT SHOWN IN STREAM BEDS WHERE GRADING IS DEPICTED.

- #### CONSTRUCTION ACCESS NOTES:
- ACCESS TO THE STAGING AREA WILL BE FROM INLET COURT.
 - CONSTRUCTION TRAFFIC ON INLET COURT SHOULD BE LIMITED TO MATERIALS AND EQUIPMENT DELIVERIES ONLY. CONSTRUCTION STAFF PARKING IS PROVIDED IN THE RESTON ASSOCIATION PAVILION PARKING AREA ADJACENT TO NORTH SHORE DRIVE.
 - CARE SHOULD BE TAKEN TO MINIMIZE DAMAGE TO SLOPE DRAINS AND VEGETATION ALONG THE EXISTING TOE OF SLOPE ADJACENT TO THE ACCESS ROAD AND INLET CLUSTER PROPERTY. CONTRACTOR IS RESPONSIBLE FOR REPAIRING ANY DAMAGE TO DRAINS. FOLLOWING CONSTRUCTION, TRAILSIDE AREAS ALONG THE TOE OF SLOPE SHALL BE SEEDED AND STABILIZED USING NATURAL FIBER MATTING. SEE PLANTING PLAN FOR DETAILS.

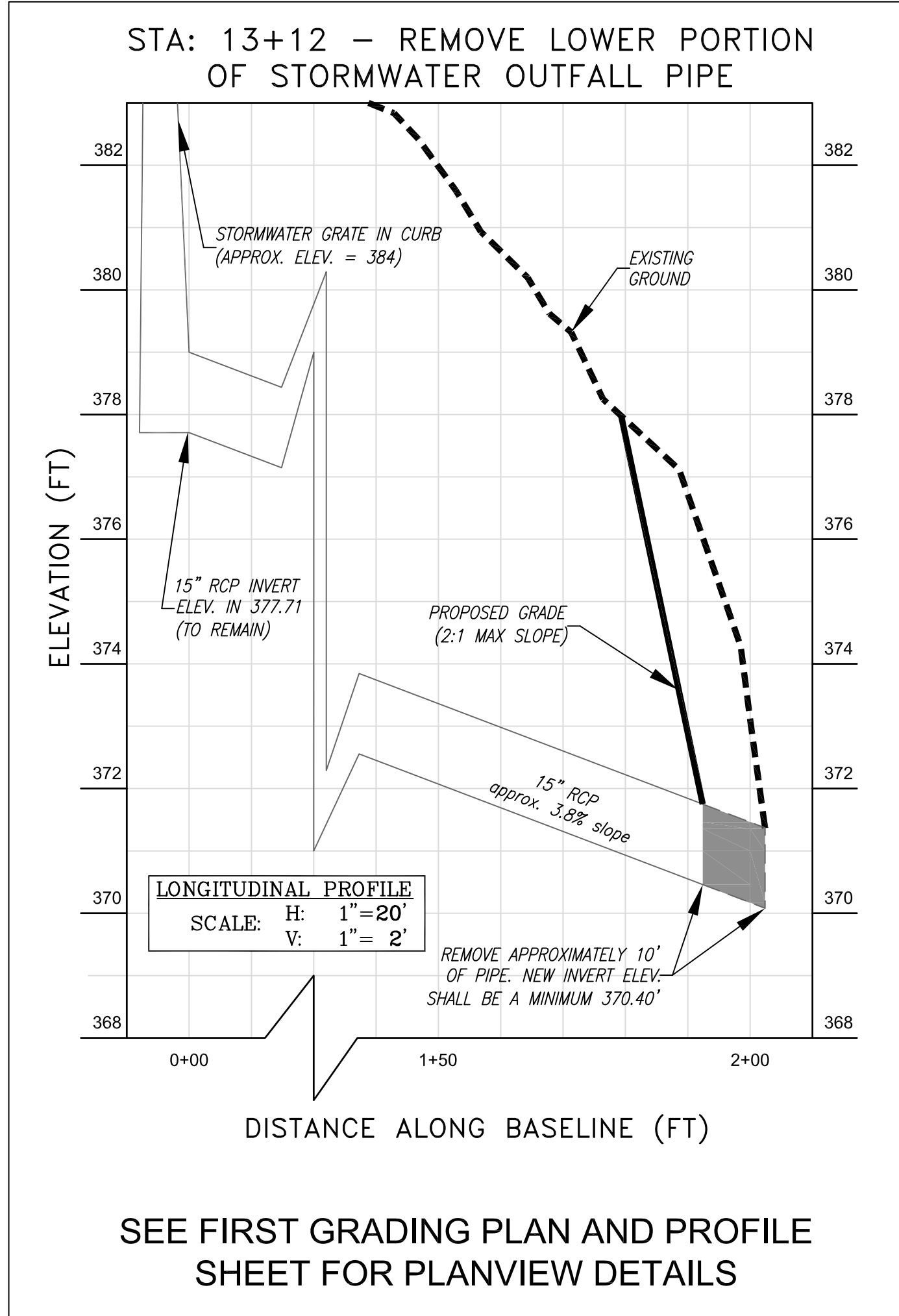

SEE FIRST GRADING PLAN AND PROFILE SHEET FOR PLANVIEW DETAILS

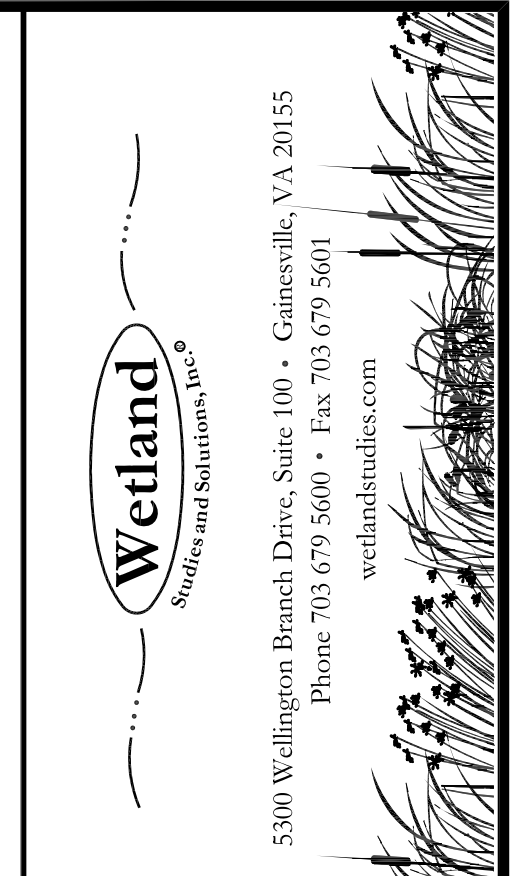

Northern Virginia Stream Restoration Bank
Lake Anne East
Fairfax County, Virginia

Grading Plan and Longitudinal Profile (cont'd)

Copyright © 2012 Wetland Studies and Solutions, Inc.



REVISIONS		App. By	Rev. By	Date	Description

DATE: MARCH 2012 SCALE: 1" = 20'

Horizontal Datum: VCS NAD 83
Vertical Datum: NGVD 29
Boundary and Topo Source: WSSI and Fairfax Digital Data

Design	Draft	Approved
NAS	NAS	FRG

Sheet #
5 of 49

Computer File Name: 1:2006-2010-02-CASD10-ENG-10-Plan.dwg
GRADING PLAN & PROFILE 10-2006.dwg