

LONGITUDINAL PROFILE - FOREST EDGE SOUTH (STA 28+00 TO 34+00) (1)

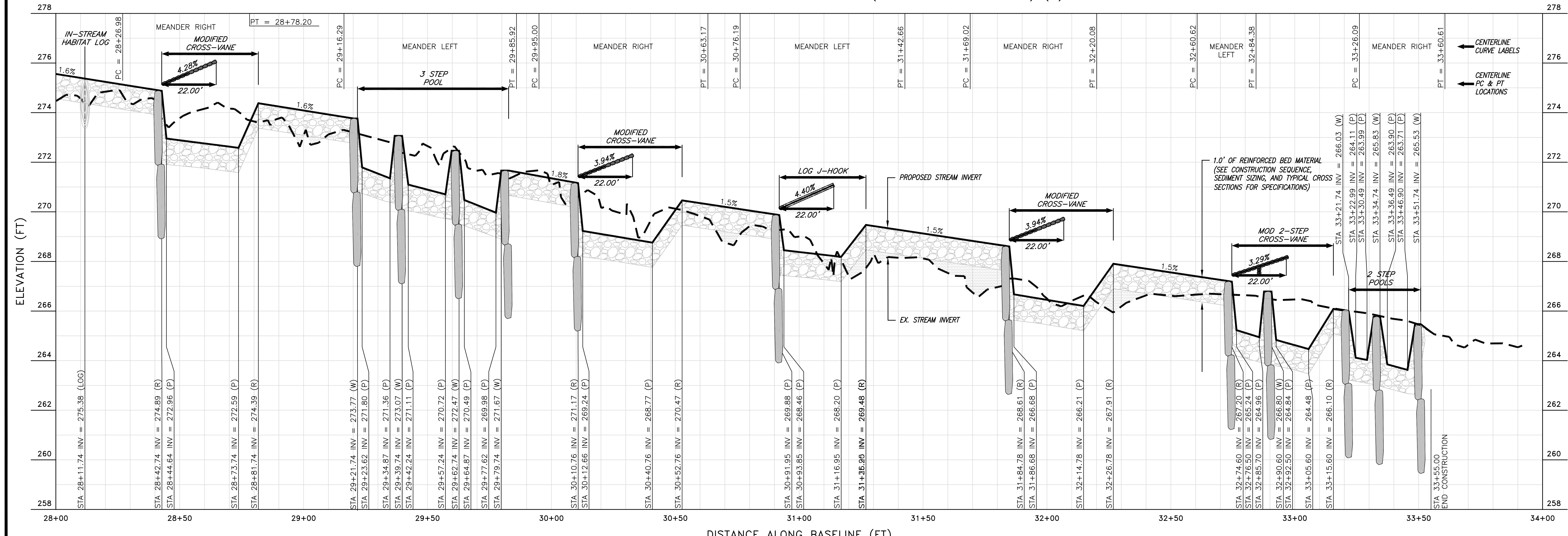

Wetland
 Studies and Solutions, Inc.
 5300 Wellington Branch Drive, Suite 100 • Gainesville, VA 20155
 Phone: 703 679 5600 • Fax: 703 679 5601
 wetlandstudios.com

Northern Virginia Stream Restoration Bank
 Colvin Run - Forest Edge South
 Fairfax County, Virginia

Grading Plan and Longitudinal Profile

Copyright © 2010 Wetland Studies and Solutions, Inc.

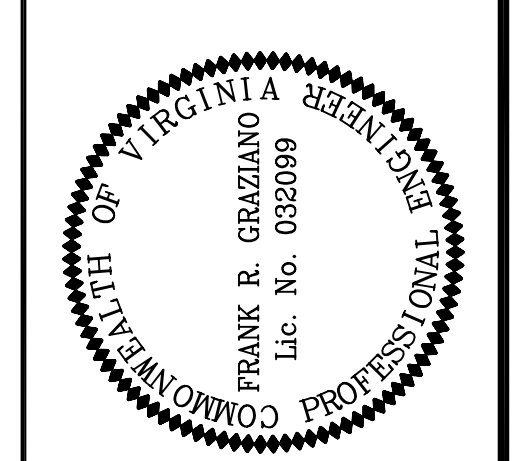

REVISIONS		App. By		Rev. By	
No.	Date	Description			

DATE: JULY 2010
 SCALE: 1" = 20'

Horizontal Datum: VCS NAD 83
 Vertical Datum: NGVD 29
 Boundary and Topo Source: WSSI and Fairfax Digital Data

Design	Draft	Approved
MSM	MSM	FRG

Sheet #
 6A of 70

Computer File Name:
 I:\2009\2010\02\CA010\ENGR10\Sheet
 GRADING PLAN & PROFILE 04-CPT1.dwg

LONGITUDINAL PROFILE
 H: 1" = 20'
 V: 1" = 2'