

REFER TO THE LAST GRADING PLAN AND LONGITUDINAL PROFILE SHEET FOR GRADING AND PROFILE LEGENDS, NOTES, AND SEQUENCE OF CONSTRUCTION.

WORK TO BE LIMITED TO WITHIN THE EXISTING CHANNEL AS MUCH AS POSSIBLE USING SUITABLE TRACKED EQUIPMENT TO LIMIT IMPACT TO TREES AND OTHERWISE STABLE BANKS.

PRIOR TO CONSTRUCTION, LOC SHALL BE WALKED WITH CONSTRUCTION SUPERVISOR AND CONTRACTOR TO CONFIRM TREE REMOVAL.

REFER TO THE TREE REMOVAL PLAN FOR TREES TO BE REMOVED. ONLY TREES SHOWN AS "TO BE REMOVED" SHALL BE FELLED.

CONTACT MISS UTILITY (800-552-7001) PRIOR TO COMMENCING ANY WORK.

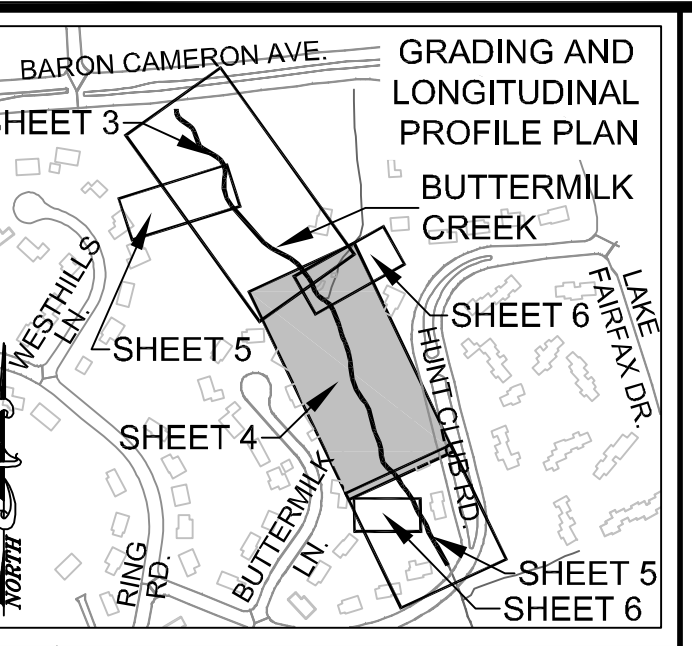

LONGITUDINAL PROFILE - BUTTERMILK CREEK (STA 16+00 TO 22+00)

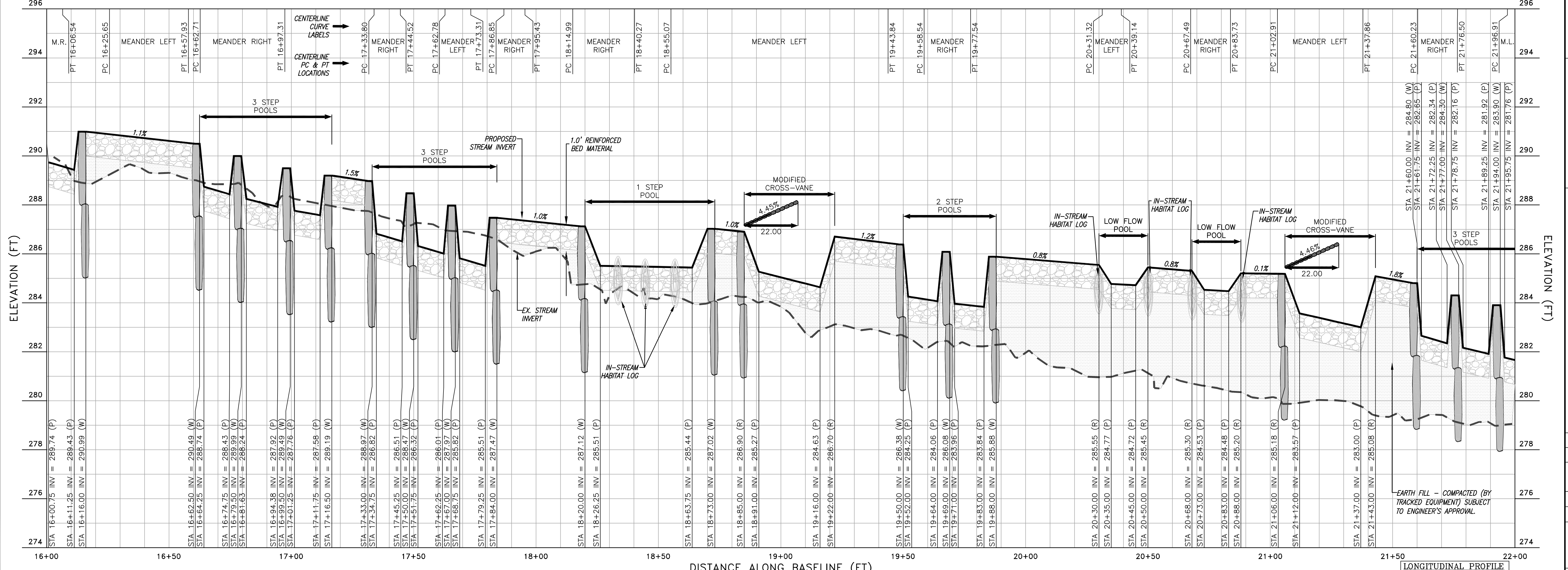

Northern Virginia Stream Restoration Bank
Colvin Run - Buttermilk Creek

Fairfax County, Virginia

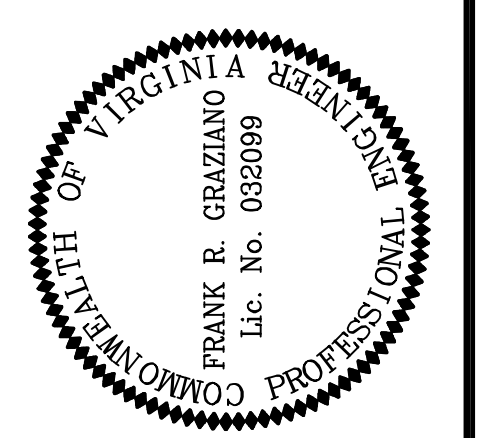

REVISIONS	
No.	Description

App. By: _____
Rev. By: _____

Horizontal Datum: VCS NAD 83
Vertical Datum: NGVD 29
Boundary and Topo Source: WSSI and Fairfax Digital Data

Design	Draft	Approved
SRP	SRP	FRG

Sheet #
4 of 54

DATE: SEPTEMBER 2012 SCALE: 1" = 20'

Computer File Name:
1:20062016-01-CDD8458-01-0404
GRADING PLAN & PROFILE 02.dwg

Wetland
Soils and Solutions, Inc.

53100 Wellington Branch Drive, Suite 100 • Gainesville, VA 20155
Phone: 703 679 5600 • Fax: 703 679 5601
wetlandsoils.com

Copyright © 2012 Wetland Soils and Solutions, Inc.

