

PROPOSED STREAM LENGTH:
BUTTERMILK CREEK = 1,440'
TRIBUTARY #1 = 227'
TRIBUTARY #2 = 120'
TRIBUTARY #3 = 54'
TOTAL STREAM LENGTH = 1,841'

PRELIMINARY PLAN LEGEND

	TEMP. GRADING & CONST. ESMNT, & INGRESS-EGRESS ESMNT		NEST
	PROPOSED STREAM ESMNT		CAVITY
	PROPOSED STREAM ESMNT, TEMP. GRADING & CONST. ESMNT, & INGRESS-EGRESS ESMNT		VERNAL POOL
	EXISTING CONTOURS (0.5')		SNAG
	EXISTING INFRASTRUCTURE		DEN
	NON-PERENNIAL STREAM (EXISTING TOP OF BANK)		ACCESS PATH
	PERENNIAL STREAM (EXISTING TOP OF BANK)		TREE TO BE REMOVED
	LTS LIMITS OF TREE SURVEY		LIMITS OF CLEARING/TREE PROTECTION FENCE
	PROPOSED BANKFULL TOP OF BANK		CHAIN LINK FENCE
	PROPOSED CENTERLINE		PEDESTRIAN GATE
	PROPOSED CONTOURS (0.5')		

DRAFT

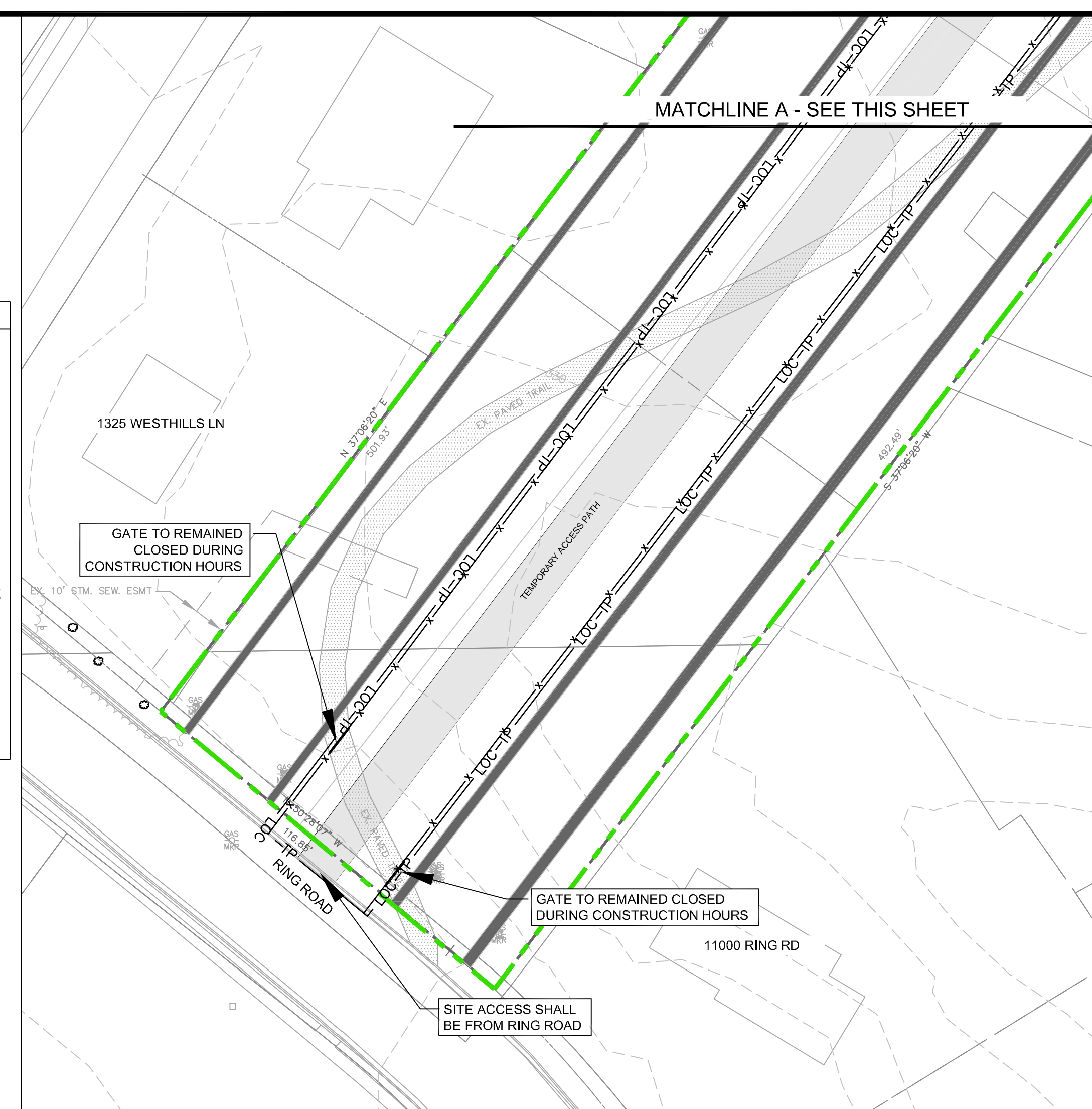
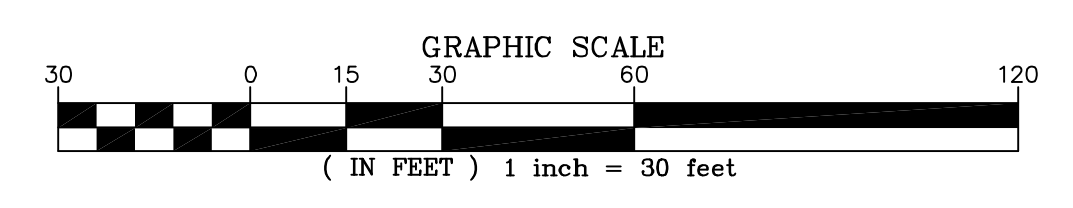

Northern Virginia Stream Restoration Bank
 Colvin Run - Buttermilk Creek
 Fairfax County, Virginia

Preliminary Plan

Copyright © 2012 Wetland Studies and Solutions, Inc.

5300 Wellington Branch Drive, Suite 100 • Gainesville, VA 20155
 Phone 703 679 5600 • Fax 703 679 5601
 wetlandstudies.com

REVISIONS									
No.	Date	Description	Rev. By	App. By	No.	Date	Description	Rev. By	App. By

DATE: FEBRUARY 11, 2012 SCALE: 1" = 30' C.I. = 0.5'

Boundary and Topo Source: WSSI and Fairfax Digital Data		
Design	Draft	Approved
SRP	SRP	FRG
Sheet #		
1 of 5		
Computer File Name: PRELIMINARY PLAN.dwg		